

11. Domestic filtration

Standard and special cartridge
Thread connection 1/4" F:

Ref.	Description	Diameter	£/uni.
FCS101	Inline sediment cartridge 12"	2 1/2"	
FCC101	Inline active carbon cartridge 12"	2 1/2"	

FCS101: This cartridge is manufactured from 100% polypropylene fiber. The high quality of this cartridge helps remove dust, sand and other particles dissolved in water.

FCC101: Removes elements such as a chlorine, particles and other organic compounds that contribute to the taste and odor of water.

Features:

- Min. temperature: 4,40 °C.
- Max. temperature: 37,70 °C.
- Max. pressure: 5 bar.
- Production: 8.000 L / year.

*25 units package



Dimensions:

- A: 285 mm
- B: 63 mm
- C: 11 mm

Ref.	Description	Diameter	£/uni.
FP1007	Inline post-carbon cartridge 12"	2"	

FP1007: Granular carbon postfilter 10".

Features:

- Min. temperature: 4,40 °C.
- Max. temperature: 37,70 °C.
- Max. pressure: 5 bar.
- Production: 8.000 L / year.

*25 units package

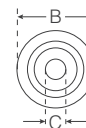

Dimensions:

- A: 270 mm
- B: 50 mm
- C: 11 mm

